

TMAX 3001HD







CE EN60974-7

CODE	↔	☐
------	---	---

MB2413	3 m	10'	
MB2414	4 m	12'	
MB2415	5 m	16.4'	

TECHNICAL DATA

		
	1,2 kg	2.76 lb
V PEAK	113	
	0,8 ÷ 1,6 mm	.030" ÷ 1/16"
X 100%	350A CO2 - 300A Mix	
	2÷4 bar	
	1,6 l/min	

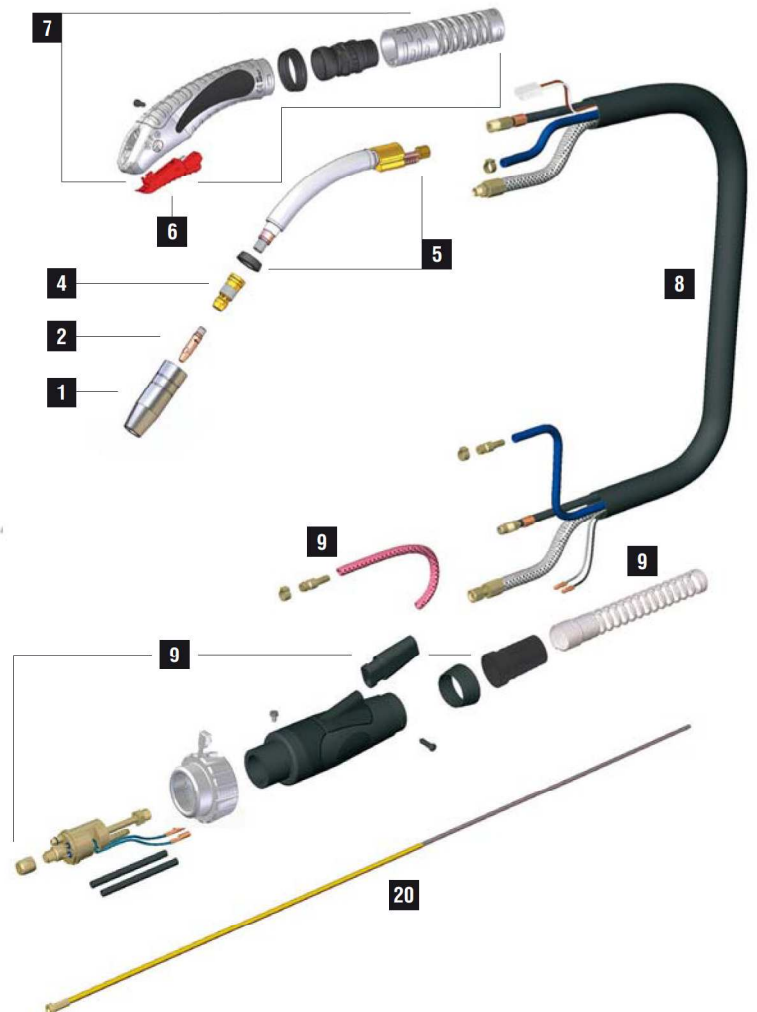

	CODE			Ø		↔	REF	
1	MC0008		MAXI 250 Spare Parts Compatibles	11 mm			-	5
1	MC0009		MAXI 250 Spare Parts Compatibles	14 mm			-	5
1	MC0010		MAXI 250 Spare Parts Compatibles	18 mm			-	5
1	MC0128			16 mm	5/8"		-	5
1	MC0129			14 mm			-	5
1	RC0000		silicon insulator inside	14 mm				10
2	MD0300-08		M7 - Cu	0,8 mm	.030"		-	20
2	MD0300-09		M7 - Cu	0,9 mm	.035"		-	20
2	MD0300-10		M7 - Cu	1,0 mm	.040"		-	20
2	MD0300-12		M7 - Cu	1,2 mm	.045"		-	20
2	MD0300-14		M7 - Cu	1,4 mm	.052"		-	20
2	MD0300-16		M7 - Cu	1,6 mm	1/16"		-	20
4	ME0369		M7 - brass TMAX 300 HD				-	5
20	GM0540		yellow steel liner	1,2 ÷ 1,6 mm	.045" ÷ 1/16"	3 m	10'	124.0041 1
20	GM0541		yellow steel liner	1,2 ÷ 1,6 mm	.045" ÷ 1/16"	4 m	12'	124.0042 1
20	GM0542		yellow steel liner	1,2 ÷ 1,6 mm	.045" ÷ 1/16"	5 m	16.4'	124.0044 1

	CODE		
5	MG0145		1
5	MQ0341		
6	BX0742		
7	MT0261		
9	AR0102		
9	BW0480		
9	FA0026		10
9	MT0101		1

	CODE	CABLE	
8	MN0080	3 m - 10' - 16 mm ²	
8	MN0081	4 m - 12' - 16 mm ²	
8	MN0082	5 m - 16.4' - 16 mm ²	

	CODE	↔	
8a	BX0733	3 m/ 10'	
8a	BX0734	4 m/ 12'	
8a	BX0735	5 m/ 16.4'	
8d	QB0076	3 m/ 10'	
8d	QB0077	4 m/ 12'	
8d	QB0078	5 m/ 16.4'	
8e	QA0019	3 m/ 10'	
8e	QA0020	4 m/ 12'	
8e	QA0021	5 m/ 16.4'	

	CODE	↔	
8f	MQ0205	3 m/ 10'	
8f	MQ0206	4 m/ 12'	
8f	MQ0207	5 m/ 16.4'	
8g	QB0090	3 m/ 10'	
8g	QB0091	4 m/ 12'	
8g	QB0092	5 m/ 16.4'	

	CODE	TMAX 3001	
4	ME0140		5
5	MG0140		1

STANDARD

FOR ALL CONSUMABLES SEE PAGE 294